

| STANDARD TANK SIZES | | | | |
|---------------------|-----------|-----|--------------------|-------------|
| CAPACITY (GALLONS) | BASE SIZE | | OVERALL TANK HT. C | TARE WEIGHT |
| | A | B | | |
| 165 | 42" | 48" | 30" | 325 lbs. |
| 350 | 42" | 48" | 51" | 475 lbs. |
| 550 | 42" | 48" | 75" | 650 lbs. |

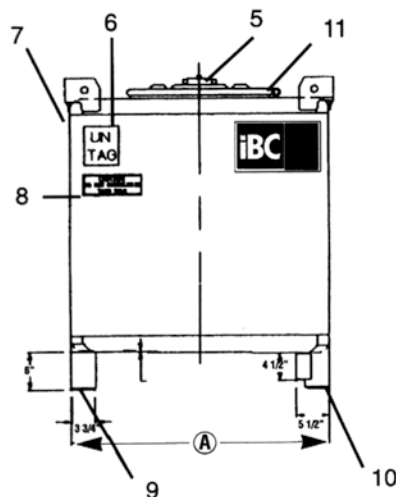

SPECS

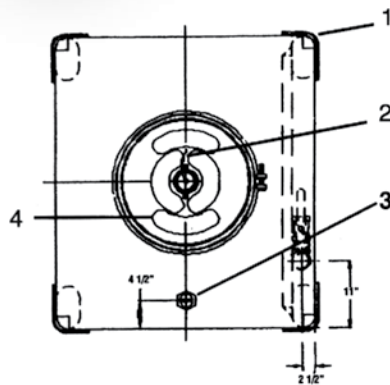

Features

1. Front and rear combo stacking/lifting lugs are specially designed to give fork clearance when stacking and unstacking units
2. Lanyard from 3" fill cap to seal lug to prevent cap being lost
3. 2" SS bung
4. Raised fork deflecting eyebrows for fitting protection and strength
5. 3" outside threaded nipple with a low profile fusible fill cap provides for ease of filling without inside thread damage
6. UN label/serial number plate
7. Radius corners for impact protection
8. Do not pressurize this tank decal
9. Fully welded, radius corner leg designed to protect tank if dropped even when loaded
10. Radius cornered leg caps for floor hang up protection
11. 22" diameter drum opening assembly with 304 SS drum cover with eyebrows, 3" fusible cap. EPDM multi-seal gasket and plated steel clamp ring
12. Full length plumbing valve guard to protect valve from fork damage, guard is positioned to allow ample hand working clearance when installing accessories to the valve
13. 2" 316 SS ball valve with PVC shipping plug and locking handle

