

PRECISION  
IBC  
INCORPORATED

PRECISIONIBCS.COM

**PRECISIONIBC.COM**



## OUR COMMITMENT TO EXCELLENCE

Precision IBC, Inc. is a major supplier of IBCs and the industry's largest and fastest growing IBC rental, sales, and service company. Our growth and success is the result of our dedication to providing innovative solutions and exceptional service to our customers. Our qualified staff has a thorough understanding of the different packaging options, and we are committed to providing you the right solution for your application with the highest level of customer satisfaction.

### INDEX

- 2.....Rental Program
- 3.....Stainless Steel - Standard Side Discharge
- 5.....Stainless Steel - Center Discharge
- 7....Square Stackable® IBC
- 8....Ultratainer® IBC
- 9....Megatainer® IBC
- 10....Flowmaster® Dry Bin
- 10....Limited Life IBC
- 11.....Precision Proline
- 12.....IBC Slings
- 12.....IBC Carriers
- 13.....Liquid Level Gauges
- 13.....Universal IBC Stands
- 14....Containment Sumps
- 15....GPS Tracking
- 15....Fire Safe Valve
- 16....IBC Heating Options
- 16....Custom Feed Systems
- 17....Stainless Steel IBC Replacement Parts
- 18....Poly IBC Replacement Parts
- 19.....IBC Intel
- 20.....The WOW Service Truck
- 21....UN/DOT Closure Requirements
- 22....Stainless Steel Fact Sheet

### SAFETY DOESN'T HAPPEN BY ACCIDENT

At Precision IBC we take great strides to create a safe work environment for our employees. We provide our team of IBC experts with the education, training and necessary tools and equipment to prevent on-site accidents and injuries. As a result of this responsibility, Precision IBC has established "Precision Safe" as the ultimate benchmark for safety promotion.

When you see the **"Precision Safe"** seal on any of our IBCs, take comfort in knowing that it comes from a place where safety is the #1 priority. And while our goal is to always strive to be a zero accident culture, we feel that is not enough. Our greater mission is to encourage everybody whom we do business with - from suppliers to customers - to also embrace the importance of a safe work environment. The "Precision Safe" seal represents the inherent value that safety is not an idea, but rather a mission we are all aiming to achieve.

All of our IBCs that carry the "Precision Safe" seal meet a standard of safety, security and performance before ever reaching our customers. And thus, a stainless steel IBC from Precision IBC gives you maximum peace of mind when shipping, handling or storing your valuable product.

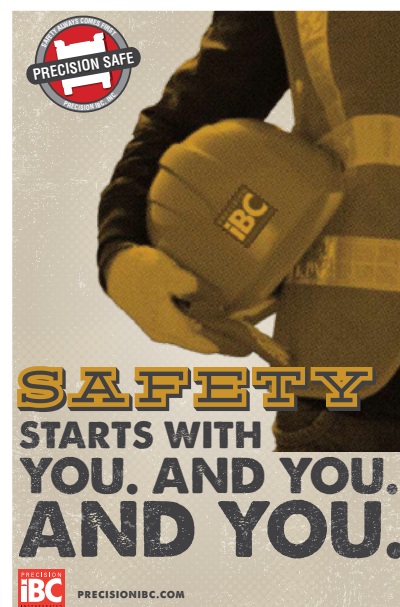

# RENTAL PROGRAM

For the right equipment at the right price, why not rent? Precision IBC's rental program is designed to save you money and guarantee that you have the right tank or accessory, when you need it, with terms that fit your requirements. Our rental program offers stable packaging costs and maximizes equipment utilization while keeping your fleet up-to-date.

## PRODUCT FLEXIBILITY

We realize there are multiple packaging options available when shipping and storing products. Renting from Precision IBC means you will never own expensive, obsolete equipment and you will always have the right container available for your application.

## BUDGETARY CONSIDERATIONS

Rental payments are not affected by changes in interest rates or fluctuation in material costs. From a purely economical standpoint, renting your equipment from Precision IBC makes perfect sense. You can plan with accuracy. For example, renting a stainless steel 550 gallon IBC from Precision IBC costs about 10¢ per gallon per month. When was the last time you paid 10¢ per gallon for anything?

## PRESERVE CAPITAL

Why tie up valuable working capital when you can improve the liquidity of your company and invest in resources more important to both growth and security? Our rental program ensures that you don't have expensive, underutilized assets wasting space and costing you money. More importantly, you maintain a healthy bottom line from a company profitability point of view.

## OUTSTANDING SERVICE

You can expect the highest level of customer service from our knowledgeable and friendly staff. Competitors may offer a similar product, but service is where Precision IBC will rise above the competition. Let us help you find the product that will best suit your needs. We are available to you 24/7 so you will have the right product at the right price, right on time.

### ITEMS AVAILABLE FOR RENTAL INCLUDE:

Stainless Steel IBCs  
IBC Carriers  
Poly Square Stackable®  
Poly Ultratainer®  
Poly Megatainer®  
Slings  
Stands

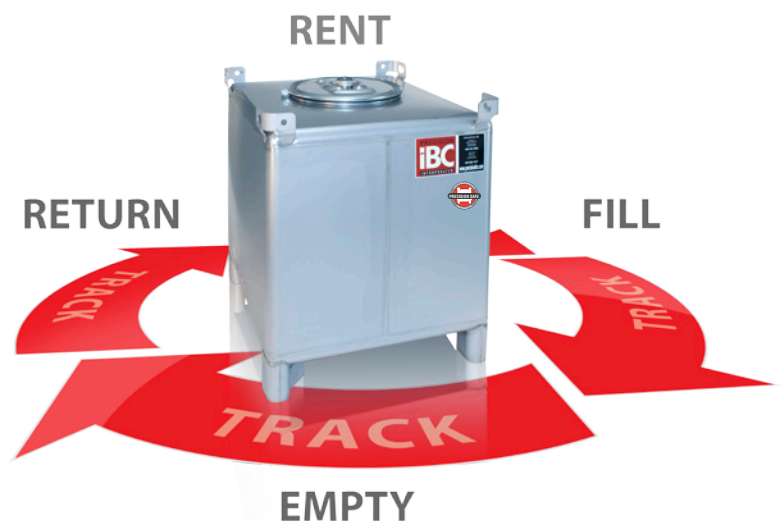

### DID YOU KNOW?

- **No minimum or maximum quantity required for our rental program.**
- **Precision IBC does not require certified cleaning on returned tanks. We make renting easy!**



**PRECISIONIBC.COM 800.544.7069**



## STAINLESS STEEL - SIDE DISCHARGE

Precision IBC's Intermediate Bulk Containers are the perfect liquid handling solution for your application. Our standard 42"x48" base tank comes with a sloped bottom allowing for virtually 100% discharge. The standard base combined with lifting lugs/leg positioners allows for safely stacking different size IBCs to help you save on space.

### EVERY STAINLESS STEEL SIDE DISCHARGE IBC COMES COMPLETE WITH THE FOLLOWING:

- UN/DOT Certified (31A)
- Packaging Group II and III per Title 49 CFR
- 1.9 Specific Gravity
- 304 Stainless Steel
- Sloped bottom for virtual 100% discharge
- 22" top manway with EPDM gasket and bolted clamp ring
- 3" top fill fitting with fusible cap and lanyard
- 2" top bung fitting
- 2" poly shipping plug
- 2" bottom discharge with lockable stainless steel ball valve
- Stainless Steel data plate
- Heavy duty lifting lugs/leg positioners
- Safety decals
- Forklift and stacking capability

### OPTIONS:

- Fork pockets
- Teeter bars
- Marine lugs
- Type 316 Stainless Steel
- Fire safe valve (see page 15)
- Tamper-evident capability

**NEW &  
RECONDITIONED  
OPTIONS AVAILABLE**



### DID YOU KNOW?

- UN31A specification permits the shipment of flammable and combustible liquids as authorized by Title 49 CFR.
- Per UN/DOT, it is the shippers responsibility to confirm product compatibility with the IBC.

Replacement parts available. Please see page 17.



<b>PRECISION IBC</b>		Fairhope, Alabama (800) 544-7069 (251) 990-6789 www.precisionibc.com		Broussard, Louisiana (888) 805-1247 (337) 839-1686	
IBC TYPE	GROUP	MFG. mm-yy	COUNTRY	MANUFACTURER	
31A	Y	MM-YY	USA	M5835	
STACKING TEST LOAD Kg	MAX. GROSS Kg	CAPACITY L	TARE MASS Kg		
7622	2722	1325	190		
TEST DATE mm-yy	INSP. DATE mm-yy	MAT'L OF CONST.			
MM-YY	MM-YY	304 SS			
MIN. THICK mm	MAX. FILL/DIS. PRES. kPa	MFG. SERIAL NO.			
2.5	0				
MODEL NO.	CAPACITY Gal	MAX. GROSS lb	TARE MASS lb	CUST. SERIAL NO.	
PRECISION SAFE	350	6000	419		
DATE RETESTED mm-yy					

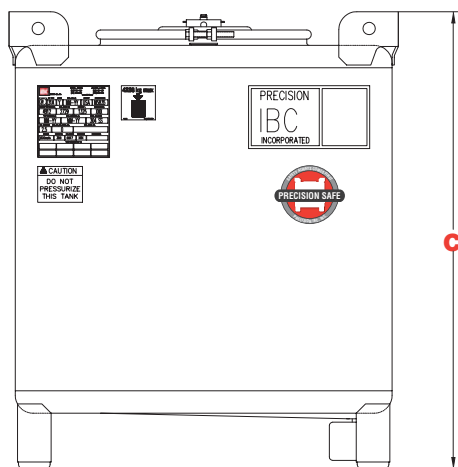
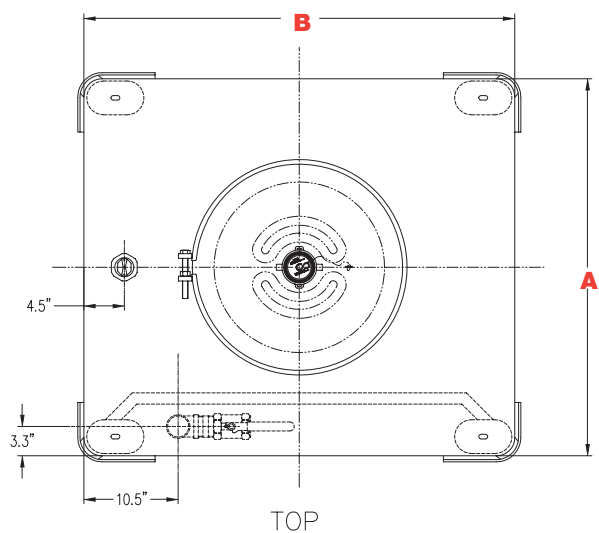

FRONT

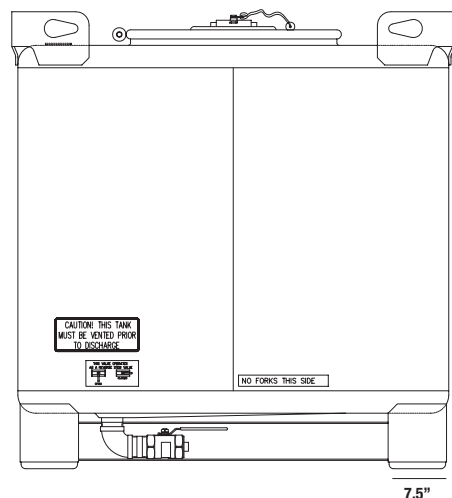

SIDE

## SIDE DISCHARGE STAINLESS STEEL IBC SPECIFICATIONS:

NOMINAL CAPACITY* [US GALLONS]	TARE WEIGHT*	LENGTH*	WIDTH*	HEIGHT*
		A	B	C
126	265 lbs	42"	48"	27"
165	325 lbs	42"	48"	30"
245	390 lbs	42"	48"	39"
350	475 lbs	42"	48"	51"
550	640 lbs	42"	48"	75"

\*All dimensions, gallons, and weights are nominal.



**PRECISIONIBC.COM 800.544.7069**

## STAINLESS STEEL - CENTER DISCHARGE

Precision IBC's Center Discharge tank provides all the same benefits as our standard side discharge tank; both have a footprint of 42"x48". Additionally, Precision IBC offers the larger SS793 gallon tank with a footprint of 54"x54", which has the same specifications as our 42"x48" footprint tanks. Precision IBC has the right center discharge tank for your unique application!

### EVERY STAINLESS STEEL CENTER DISCHARGE IBC COMES COMPLETE WITH THE FOLLOWING:

- UN/DOT Certified (31A)
- Packaging Group II and III per Title 49 CFR
- 1.9 Specific Gravity
- 304 Stainless Steel
- Center discharge drain
- Sloped bottom for virtual 100% discharge
- 22" top manway with EPDM gasket and bolted clamp ring
- 3" top fill fitting with fusible cap and lanyard
- 2" top bung fitting
- 2" bottom discharge with lockable stainless steel ball valve
- 2" poly shipping plug
- Fork channels, 7 gauge
- Stainless Steel data plate
- Heavy duty lifting lugs/leg positioners
- Safety decals
- Forklift and stacking capability

### OPTIONS:

- Marine lug
- Type 316 Stainless Steel
- Fire safe valve (see page 15)
- Tamper-evident capability



**NEW &  
RECONDITIONED  
OPTIONS AVAILABLE**



### DID YOU KNOW?

Information including: UN certification code, material of construction, tare weight, maximum gross weight, serial number and original date of manufacture is found on the stainless steel data plate welded on every UN/DOT stainless steel tank. (See detailed drawing on page 4.)

Replacement parts available. Please see page 17.

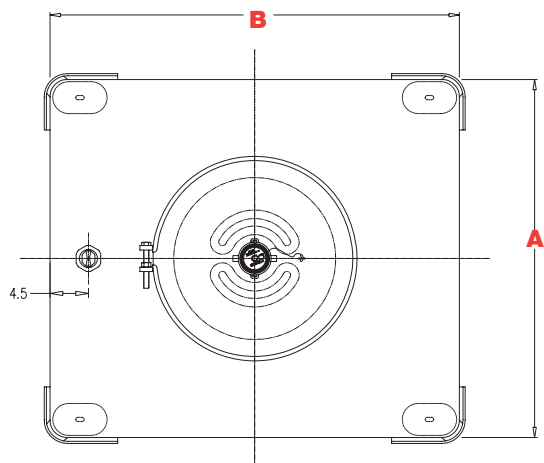

TOP

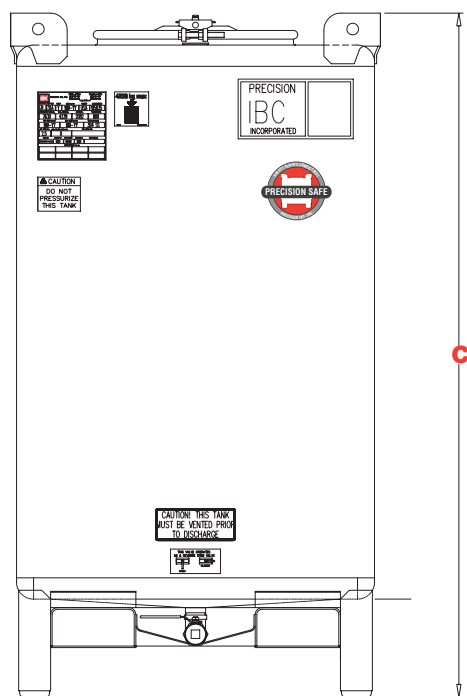

FRONT

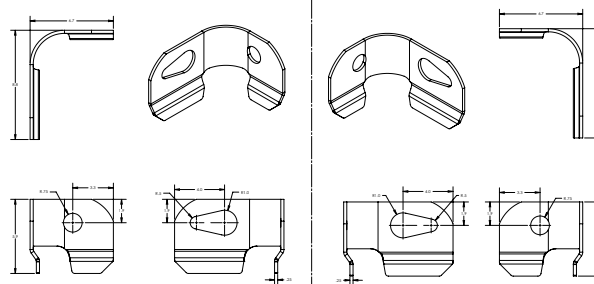

Lifting lugs/leg positioners

### DID YOU KNOW?

- Tare weight is the weight of an empty container
- According to SP12412, our stainless steel tanks installed with a fire safe valve can be used to pump off hazardous materials with a flash point of 100°F from the vehicle in which they are transported (see page 15)

## CENTER DISCHARGE STAINLESS STEEL IBC SIZES:

CAPACITY* [US GALLONS]	TARE WEIGHT*	LENGTH*	WIDTH*	HEIGHT*
		A	B	C
350	598 lbs	42"	48"	53"-56"
550	768 lbs	42"	48"	77"-80"
793	1041 lbs	54"	54"	80"

\*All dimensions, gallons, and weights are nominal.

\*Overall tank height plus or minus 3 inches depending on leg height. Call for questions



**PRECISIONIBC.COM 800.544.7069**



## SQUARE STACKABLE® IBC

The Square Stackable is the industry's best selling, all poly IBC providing value in long term, reusable applications for both hazardous and non hazardous liquids. Designed for easy, safe handling, the Square Stackable is available in both Heavy Duty and Premium models.

### FEATURES:

- UN/DOT Certified (31H2)
- Packaging Group II and III per Title 49 CFR
- ½" wall thickness HDPE
- 1.9 Specific Gravity
- 6" screw cap with security tether
- 2" plastic vacuum relief vent
- Two 2" bungs in the top of the tank
- 2" standard port male camlock bottom drain valve with dust cap
- Molded-in and inked gallonage markers
- Forklift and stacking capability

### OPTIONS:

- Tamper-evident capability
- Base Option: Heavy Duty Base provides 30% more tank surface protection
- Base Option: Premium Base provides forklift pockets
- Viton gasket package
- Molded-in company logos and product information



### PREMIUM SQUARE STACKABLE SPECIFICATIONS:

CAPACITY* [US GALLONS]	TARE WT*	BASE*	HEIGHT*
<b>120 Premium</b>	185 lbs	45" x 45"	36 ½"
<b>220 Premium</b>	211 lbs	45" x 45"	48 ½"
<b>275 Premium</b>	232 lbs	45" x 45"	56"
<b>330 Premium</b>	257 lbs	45" x 45"	63 ½"

### HEAVY DUTY SQUARE STACKABLE SPECIFICATIONS:

CAPACITY* [US GALLONS]	TARE WT*	BASE*	HEIGHT*
<b>120 HD</b>	160 lbs	45 ¾" x 45 ¾"	34 ¼"
<b>220 HD</b>	188 lbs	45 ¾" x 45 ¾"	46 ¼"
<b>275 HD</b>	209 lbs	45 ¾" x 45 ¾"	53 ¾"
<b>330 HD</b>	234 lbs	45 ¾" x 45 ¾"	61 ¼"

\*All dimensions, gallons, and weights are nominal.



Replacement parts available. Please see page 18.

# ULTRATAINER® IBC

Unique cylindrical tank design eliminates corners, ribs and seams, and lends itself well to mixing and cleaning operations. Each tank is designed for easy, safe handling and has forklift and stacking capability.

## FEATURES:

- UN/DOT Certified (31H1)
- Packaging Group II and III per Title 49 CFR
- ½" wall thickness HDPE
- 1.9 Specific Gravity
- Pressure rated to 15 PSI
- 6" screw cap with security tether
- 2" plastic vacuum relief vent
- Two 2" bungs in the top of the tank
- 2" standard port male camlock bottom drain valve with dust cap
- Molded-in and inked gallonage markers
- Forklift and stacking capability

## OPTIONS:

- 20" lid opening for applications requiring more access to tank's interior for mixing or cleaning
- Heavy weight (62 PSI) option available
- Optional retractable lifting lugs offer superior top-lifting capacity with crane-hook attachments
- Teeter bars
- Tamper-evident capability



**NEW &  
RECONDITIONED  
OPTIONS AVAILABLE**



## SPECIFICATIONS

CAPACITY * [US GALLONS]	TARE WT*	LENGTH*	WIDTH*	HEIGHT*
220	268 lbs	46"	46"	54"
275	289 lbs	46"	46"	62"
330	309 lbs	46"	46"	70"

\*All dimensions, gallons, and weights are nominal.

## DID YOU KNOW?

Per UN/DOT, it is the shippers responsibility to confirm product compatibility with the IBC.

Replacement parts available. Please see page 18.



**PRECISIONIBC.COM 800.544.7069**



## MEGATAINER® IBC

The industry's largest UN/DOT all poly IBC can ship hazardous and non-hazardous liquids up to 550 gallons. This versatile tank allows the shipment of bulk liquids cost effectively without jeopardizing safety or the environment. Because of the unique footprint, the forklift operator can access the poly IBC from either side or end. The shorter height, compared to vertical tanks, makes the Megatainer an excellent option where height restrictions apply without sacrificing gallonage.

### FEATURES:

- UN/DOT Certified (31H2)
- Packaging Group II and III per Title 49 CFR
- ½" wall thickness, HDPE Linear
- 1.9 Specific Gravity
- Two 2" bungs, one in tank top and one in tank lid
- 2" plastic vacuum relief vent
- 6 ½" heavy-duty fill cap with tether
- 2" full port bottom drain valve with dust cap
- Molded-in and inked gallon markers
- Forklift and stacking capability



### OPTIONS:

- Tamper-evident capability
- EPDM or Viton gaskets

### DID YOU KNOW?

- Top lifting assembly is available with our Megatainer®.
- Per UN/DOT it is the shippers responsibility to confirm product compatability with the IBC.

## SPECIFICATIONS

CAPACITY* [US GALLONS]	TARE WT*	LENGTH*	WIDTH*	HEIGHT*
550 LX	542 lbs	81"	48"	60"
550	573 lbs	81"	48"	60"

\*All dimensions, gallons, and weights are nominal.

Replacement parts available. Please see page 18.



**PRECISIONIBC.COM 800.544.7069**



## FLOWMASTER®

The Flowmaster poly dry bulk bin is designed with an 8" or 12" valve and a 45 degree hopper for dry flowable materials. Multiple top opening, valve options and custom sizes are available to handle your dry movable application.

### FEATURES:

- ½" thick all plastic HDPE construction
- Seamless, smooth interior surface
- Butterfly, slide gate, iris and sanitary valves available
- Forklift and pallet jack accessible

### SPECIFICATIONS

CAPACITY*	BASE*	HEIGHT*
25 cu ft	48" x 48"	54 ¾"
40 cu ft	48" x 48"	67"
50 cu ft	48" x 48"	77 ¼"
60 cu ft	48" x 48"	83 ¾"
80 cu ft	48" x 48"	100 ½"

\*All dimensions and weights are nominal.

### OPTIONS

- Flowmaster for viscous products
- Other capacities available with 60° hopper
- Multiple top opening options available
- Optional retractable lifting lugs



## LIMITED LIFE IBC

Our limited life IBC comes with a rigid welded galvanized tubular steel grid. The pressed galvanized steel base shape supports the inner container and assists with the total discharge.

### FEATURES:

- HDPE bottle
- Certified UN31HA1
- 6" screw cap
- Forklift and stacking capability
- 2" poly discharge valve
- Approximately 1/10" bottle thickness

### SPECIFICATIONS

CAPACITY* [US GALLONS]	TARE WT*	BASE*	HEIGHT*
275	132 lbs	40" x 48"	45"
330	137 lbs	40" x 48"	53"

\*All dimensions, gallons, and weights are nominal.

Replacement parts available. Please see page 18.



**PRECISIONIBC.COM 800.544.7069**

# PRECISION PROLINE

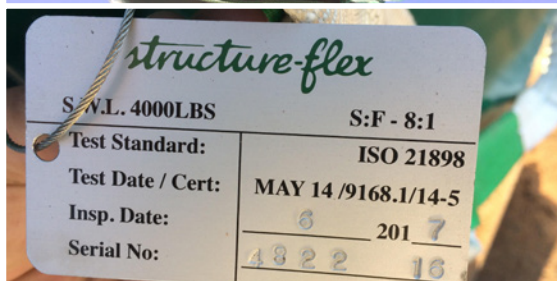

## ***A Safe, Convenient and Affordable Answer to Bulk Storage***

Precision Proline, formerly Proline Systems, Inc, rents reusable and returnable bulk bags for offshore drilling, chemical, food, and pharmaceutical industries. The complete Precision Proline System is designed to eliminate waste and disposal problems, prevent worker injuries and reduce exposure to dust and particles.

### **BULK SYSTEM BAGS:**

Precision Proline's bulk bags are reusable and capable of holding a volume of 50 ft<sup>3</sup> or 4000 lbs, the safe working limit. Our bulk bag can replace the inefficient 50 lb paper sack and save you money. Ask about any of the following bags today:

- EcoDry Bag
- Econo Bag
- Enviro Bag
- Custom Bags

### **DID YOU KNOW?**

- Our bulk bags can protect your dry products from water and sunlight, with no harmful deterioration as compared to other disposable bags.
- We track and maintain certifications for each of our bags.

### **SAVE SPACE**

Our bulk bags can be lifted by crane or forklift. The empty bags collapse to 1/20 of their full volume which allows for compact shipping to the filling points of origin.

### **REDUCE WASTE**

Our entire line of bulk bags reduce waste, they are shipped without shrink wrap, and since they are returnable/reusable, there are no paper sacks to discard! Additionally, our bags are waterproof, protecting excess product from the elements and preserving your product for the next job.

### **REDUCE INJURIES**

Active mud systems on deepwater rigs can range from 15,000 to 25,000 barrels a day requiring large amount of chemicals on a daily basis. Our bags virtually eliminate lifting injuries by removing the need for 50lb or 100lb paper sacks. Also, dust inhalation is drastically reduced because our bags employ a unique discharge sleeve that eliminates the need to cut the sack and allows product discharge control.

## IBC SLINGS

Precision IBC offers wire slings compatible with our IBCs and carriers. Our standard four leg wire sling is corrosion resistant and perfect for Gulf of Mexico offshore use. Slings are serialized for identification and tracking purposes, and are also available under our rental program.

### FEATURES:

- ½" x 5' drawn galvanized, four leg sling
- 1" Master link on sling top
- Galvanized, heavy duty thimble on each end
- 5/8" bolt-type safety shackle at the bottom of each leg

### OPTIONS:

- 6 ft. sling option also available
- Custom builds to meet your specific requirements/specifications
- Additional shackle options
- DNV 2.7-1 spec

### DID YOU KNOW?

Our clamp ring protector (part #1447) helps prevent your sling from hanging up on the clamp ring bolt.

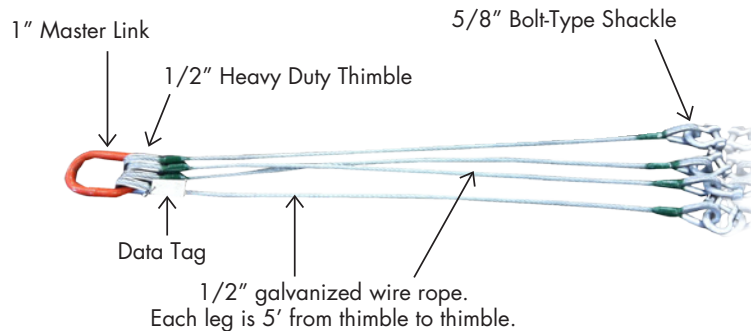

## IBC CARRIERS

Our Precision Safe Carrier is the answer to offshore loading and unloading nightmares.



### FEATURES:

- Certified to DNV Standards
- Maximum Gross Weight Rating: 11,000 lbs
- Tare Weight: 1700 lbs
- Maximum Safe Working Load: 9,300 lbs
- Galvanized carbon steel
- Dual locking loading door
- Top loading capability
- Solid floor providing a drip pan with drain
- Four way enclosed fork pockets
- Flush outside surfaces
- Built-in 4" strapping
- Top protector available on request
- Can accommodate all standard IBC's



**PRECISIONIBC.COM 800.544.7069**



## LIQUID LEVEL GAUGES

Precision IBC offers a variety of level gauge options to fit your specific application including Krueger At-A-Glance direct reading level gauges and Kenco Engineering side-mount or bottom plumbing bulk tank gauges.

### AT-A-GLANCE FLOAT GAUGE FEATURES:

- 3 piece construction
- Red lock nut - HDPE Plastic available in aluminum or PVC
- Bushing - aluminum available in 1 1/2" or 2".
- HDPE float - available in stainless or Nitrophyll
- Internal rods - standard construction is galvanized steel rods with brass rivets. Stainless Rods available.



### KENCO 8800 SERIES LEVEL GAUGE:

- 90° connections for ease of installation
- Gauge is fitted with inline 1/4" FNPT vent and drain connections
- 3 sides are enclosed with a metal frame
- Gauge face is protected with a polycarbonate shield
- Shield can be custom calibrated to read tank volume or any other calibration



#### DID YOU KNOW?

Welding on the sidewall of your tank voids the UN/DOT certificate.

## UNIVERSAL IBC STANDS

Our universal tank stands offer easy access and discharge of IBCs at various heights. These stands accommodate stainless or carbon steel IBCs as well as poly or limited life containers, and can handle side and center discharge tanks. Horizontal support bracing is offset so buckets or other containers can be placed directly under the valve. Stands are constructed of carbon steel, painted and safety striped.

### FEATURES:

- 40" x 46" base dimension
- 12" wide top platform panels
- 46" x 50" overall top platform dimension
- 22" between top panels

### ADDITIONAL INFORMATION

- Standard sizes include: 12", 24", 36", 48", and 54" heights
- Custom stands available
- Dirt base option available



# CONTAINMENT SUMPS

Protect your company against hazardous IBC spills with the portable, cost effective protection of the Saf-Tainer®. It is the most cost effective system on the market today. The unique polyethylene design reduces the risk of unrecoverable spills and protects the environment. Its economical price and versatile design saves you money while safely addressing your company's safety, health and environment concerns.

## FEATURES:

- Meets 40 CFR 264.175
- 100% polyethylene construction
- 8000 lb. static load capacity
- 2" bottom drain plug
- Removable internal platform can be used as an IBC stand
- 485 gallon sump capacity
- Forklift channels for portability



## DID YOU KNOW?

Saf-Tainer containment basins are compatible with all poly IBCs up to 330 gallon and metal IBCs up to 350 gallon. (Top grating required.)

Our metal containment sumps offer 110% product containment for all industrial applications and comply with EPA and OSHA regulations. Constructed of 10 gauge carbon steel with galvanized grating, these durable sumps can be made for any size tank. Spills are easily recovered with the 2" drain plug.

## FEATURES FOR A 55-GALLON:

- 60" x 96" base dimension
- 25" overall height
- 625 gallon capacity
- Powder coat painted

## ALSO AVAILABLE

- Custom sizes to accommodate height or floor space restrictions, as well as other capacities
- Stainless steel construction option



## GPS TRACKING

### RUGGED CAPABILITIES FOR RUGGED CONDITIONS

When you are in charge of monitoring valuable assets, do you have a lot of questions?

- Where is my equipment?
- Where has it been?
- How long has it been gone?
- When will it be ready for the next job?

Our GPS-based equipment tracking solution answers those questions for you—instantly. It gives you on demand control over your high value, mobile, dispersed and remote equipment. You will know that your tanks are secure and accounted for, whether they are in your facility or halfway around the world. Get the answers you need for strategic decision making, such as current and historical location data for your tanks, worldwide, all in a user-friendly integrated system.

## FIRE SAFE VALVE

- Easily and affordably retrofits some Center and all Side Discharge IBCs
- Ideal for 350, 550 and 793 tanks
- Meets the requirements of 178.275 (d) (3) or 178.345-11 which allows for discharging an IBC without removing it from the transport vehicle.
- Stainless steel ball valve with high tensile carbon steel actuator spring
- Fusible link set to activate at not more than 250 degrees F
- 100% test air under water at 100psi
- Working pressure 1,000 psi WOG
- Temperature range -60 to 450 degree F
- Positive seal in the closed position
- End types: NPT threaded

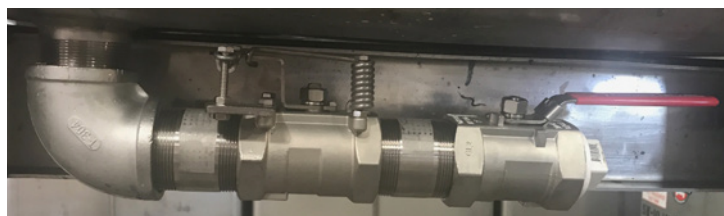

\*Above photo: Example of Fire Safe Valve installed on Side Discharge Stainless Steel Tank with a reverse handle ball valve

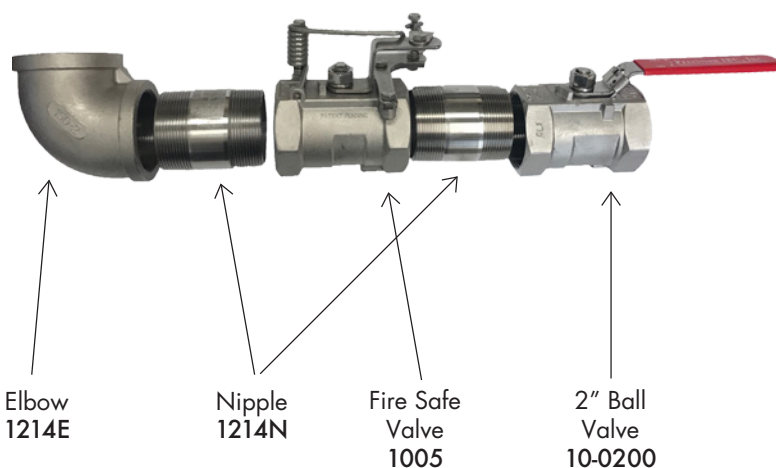



## IBC HEATING OPTIONS



### BELLY BAND IBC HEATERS

Work with all metal IBCs and provide a practical, efficient means of freeze protection, viscosity control and maintenance of materials at elevated temperatures.



### WRAP-AROUND IBC HEATERS

Speed up the flow of slow moving and uncooperative contents such as honey, molasses and lube oil and are designed to work with caged, plastic or metal IBCs.



### INSULATING IBC BLANKETS

Are made of Herculite high performance industrial fabric with 1/2" dense foam insulation for ultimate durability. Custom made to fit any metal or poly IBC.



### INTERNAL COIL

Is a lid mounted heating or cooling option for metal IBCs constructed of 1" schedule 40 stainless steel pipe with 1" NPT inlet and outlet fittings. The coils work with steam, hot water, or glycol-based mediums and can also be used for cooling.



### HEATING/COOLING PANELS

Can be applied to 1 to 4 sides of a metal IBC during manufacturing and work with steam, hot or cold water, or glycol-based mediums. Inlet and outlet fittings are 1" NPT. (Not recommended for UN tanks.) Heating/cooling panels void the UN/DOT tank designation.

### DID YOU KNOW?

The temperature range for stainless steel IBCs is -20°F to 250°F.

## FEED SYSTEMS



Piggyback feed systems offer the convenience of receiving a transporter tank onto a permanent base tank. Keep your product flowing with Precision IBC's feed system including a 12" universal spacer stand and discharge hose.

### ALSO AVAILABLE

Custom feed systems for your specific application.



## STAINLESS STEEL REPLACEMENT PARTS

Precision IBC carries a full line of replacement parts for your tanks. If you don't see the item you are looking for, be sure to visit our website [precisionibc.com](http://precisionibc.com), or contact one of our knowledgeable packaging consultants.



L1196B .....22" lid with 3" nipple  
L1197A .....22" lid with 2" Reike vent  
L1196BX.....22" lid with extra bung



1140A .....3" fusible cap  
1131.....3" Teflon gasket  
1137.....3" Buna gasket

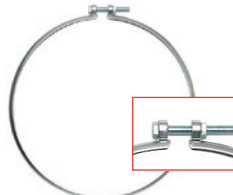

1061.....22" plated clamp ring  
w/ nut & bolt  
1015.....22" SS clamp ring



1126..... 22" EPDM thick gasket  
1126V..... 22" EPDM gasket full overlap  
1123BFW.. 22" Teflon coated gasket  
1124..... 22" Viton coated gasket  
1123B..... 22" Teflon coated gasket - blue



10-0200.....2" reverse handle  
SS ball valve  
10-0201.....2" standard handle  
SS ball valve  
10-0200A.....2" reverse handle  
SS ball valve w/ QC  
1005.....2" emergency valve  
SS ball valve w/ QC



1214.....2" SS dust cap  
1043.....2" poly dust cap  
1148.....2" EPDM dust cap gasket  
1148V.....2" Viton dust cap gasket



1113T.....3" 5:1 vent, Teflon gasket  
1113V.....3" 5:1 vent, Viton gasket



1208.....No Forks This Side  
Caution Vent Tank  
Caution Do Not Pressurize  
Valve Open/Close  
Valve Close/Open (reverse)



1038.....2" SS hex bung plug  
1037DSS.....2" SS round bung plug  
1127.....2" Reike bung gasket, EPDM  
1127WE .....2" EPDM bung gasket  
1130.....2" Teflon bung gasket



1105.....2" poly shipping plug



1447.....22" clamp ring protector  
1446.....Sling guard, red



1214E.....2" SS elbow  
1214N.....2"x 3" SS nipple



1210.....2" SS adapter, straight



1210A.....2" SS adapter, 15 degree



1112T.....2" 3:1 vent, Teflon  
1112V .....2" 3:1 vent, Viton  
1079 .....2" Reike fusible vent  
1118 .....2" smart vent, Teflon  
1320B.....2" vac/pressure vent, Viton  
1320 .....2" double vacuum vent, Viton

# POLY IBC REPLACEMENT PARTS

As a major distributor for many poly IBC manufacturers, we stock a wide variety of the most commonly used replacement parts, with no minimum order requirement. Please call us if you need assistance.



1056C ..... 6" cap with 2" bung, EPDM  
1056CV ..... 6" cap with 2" bung, Viton



1056B ..... 2" vacuum vent, EPDM  
1056V ..... 2" vacuum vent, Viton  
1320B ..... 2" vacuum pressure vent, Viton



1056G ..... 6" EPDM gasket  
1055V ..... 6" Viton gasket



1040 ..... 2" poly ball valve  
1043 ..... 2" poly dust cap  
1148 ..... 2" dustcap gasket, EPDM



1035A ..... 2" poly plug



1159A ..... 2" replaceable bung  
1159B ..... 2" EPDM "O" ring  
1159V ..... 2" Viton "O" ring



1056A ..... 6" cap with 2" bung, EPDM  
1056AV ..... 6" cap with 2" bung, Viton  
1035A ..... 2" poly plug



1056B ..... 2" vacuum vent, EPDM  
1056V ..... 2" vacuum vent, Viton



1040M ..... 2" poly full port ball valve



1056AGE ..... 6" EPDM gasket  
1056GV ..... 6" Viton gasket



1043 ..... 2" poly dust cap  
1148 ..... 2" dustcap gasket, EPDM



1320B ..... 2" vacuum/pressure relief vent, Viton



1081L ..... 6" cap with 2" bung, EPDM  
1035A ..... 2" poly plug  
1320B ..... 2" vacuum pressure vent, Viton



1041 ..... 2" poly adapter, FML NPT x ML QC  
1044 ..... 2" poly adapter, ML NPT x ML QC  
1043 ..... 2" poly dustcap



1081VC ..... 2" poly ball valve  
1148 ..... 2" dust cap gasket EPDM  
1531B ..... 2" screw cap, NPT





## IBC INTEL INVENTORY MANAGEMENT

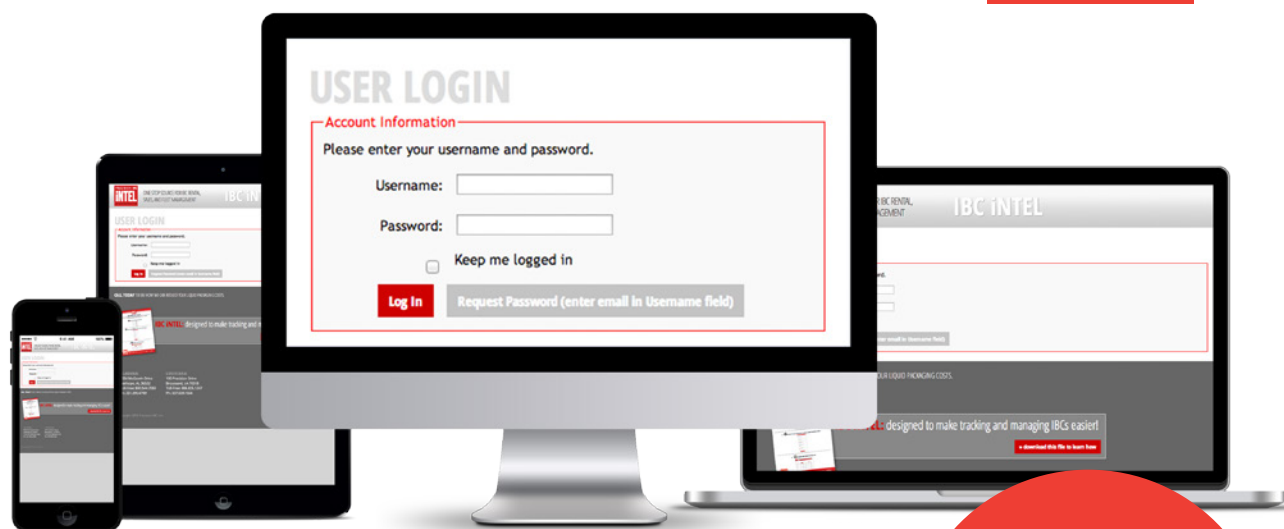

### **IBC INTEL IS A SECURE CUSTOMER PORTAL THAT ALLOWS OUR CUSTOMERS TO MONITOR FLEET INVENTORY, TRACK REGULATORY TEST DATES, AND DOWNLOAD AND PRINT TEST CERTIFICATES 24/7.**

- Avoid regulatory fines - know when your tanks need certification and print test certificates 24/7
- Compare fleet management to previous years
- Track business growth and predict inventory needs
- View tanks according to location

A key issue with maintaining inventory is keeping the optimum sized fleet of assets running at the lowest possible cost. Immediate, accurate and up-to-date information about your fleet provides a utilization control mechanism for costs as well as simplifies fleet maintenance.

IBC Intel, Precision IBC's secure customer portal, allows customers to review fleet inventory, track regulatory test dates, and download and print test certificates all in a web-based format. There is no new software to purchase or install. On demand access to information is available anytime, day or night.



**PRECISIONIBC.COM 800.544.7069**



**THE WOW SERVICE TRUCK**  
**WHAT YOU NEED.**  
**ON TIME.**  
**WHEN YOU NEED IT.**



**OUR FULLY EQUIPPED PRECISION IBC WOW TRUCK IS ON THE ROAD PROVIDING ON-SITE TESTING, MINOR REPAIRS AND SMALL PARTS DELIVERY:**

- Minimize your IBC downtime by quickly getting them back in service
- Avoid unnecessary freight charges
- Inventory of spare and replacement parts
- No additional cost for the delivery of parts with your scheduled recertification
- Avoid fines for recertification — Complete UN/DOT testing including 2.5 year pressure test and 5 year thickness test
- On-site testing beyond 50 miles **WILL** incur a travel charge. Minimum of 10 tanks required.

*“We’re in the Water Treatment Chemical Manufacturing business and needed some repairs on a few of our IBCs. I called Precision IBC and they sent out the WOW truck that very day. They pressure tested each IBC for leaks, and replaced some bung plugs & ball valves. Marvin was honest, friendly and professional. We will definitely be using the WOW truck again the next time we need to re-certify our tanks.”*

- Precision IBC customer



**PRECISIONIBC.COM 800.544.7069**



## UN/DOT CLOSURE REQUIREMENTS

Per 49 CFR 178.2(c)(1)(ii), the below listed closure and gasket information should be followed:

### METAL 31A AND 31B CLOSURE DESCRIPTIONS

2" and 3" threaded fittings with all gasket materials except Teflon	3/8-1/2 rotations beyond full/solid gasket contact or minimum torque value of 30 ft-lbs
2" and 3" threaded fittings with Teflon gasket	1/8-3/16 rotations beyond full/solid gasket contact or minimum torque value of 60 ft-lbs
22" clamp ring with multi-seal gasket	<p>Seat the ring by striking with non-sparking mallet such as a rubber mallet around the circumference of the ring. Tighten the 5/8" bolt and then restrike the ring with the mallet. Alternate between tightening and striking until the bolt tightening resistance does not change.</p> <p><i>NOTE: The ring ends should be approximately 3/8" apart and must not meet</i></p>

### ROTATIONALLY MOLDED 31H2 AND 31HA1 CLOSURE DESCRIPTIONS

6" cap, all gasket material	1/8 - 1/16 rotation beyond contact
2" NPS (NPT) threaded bung plugs, pressure/vacuum relief vents	3/8 - 1/2 rotation beyond contact
All bottom drain valves	<p><i>NOTE: Not to be screwed in until 0.5 - 3 threads remain visible.</i></p> <p>The exterior compression clamp should be tightened until it cannot be rotated around the tabulation. A leak test per 49 CFR 178.813 is required after valve installation.</p>

### BLOWMOLDED 31HA1, 31HG1 AND 31HH1 CLOSURE DESCRIPTIONS

6" cap, all gasket material	Rotation beyond contact or torque to 55ft lbs.
2" NPS (NPT) threaded bung plugs, pressure/vacuum relief vents	3/8 - 1/2 rotation beyond contact or torque to 55ft lbs.
Valve nut	1/8 rotation beyond contact or torque to 55ft lbs.



# STAINLESS STEEL IBC FACT SHEET

## FEDERAL TESTING REQUIREMENTS – 49 CFR 178.2(c)(1)(ii)

Pressure Test	Once every 2 ½ years*
Thickness Test	Once every 5 years*

## GALLONS PER INCH

42" x 42" Base	7.64 gallons
42" x 48" Base	8.73 gallons
54" x 54" Base	12.3 gallons

## TOTAL PER TRUCKLOAD

SS-350 Gallons	56 each per standard 53' trailer
SS-550 Gallons	28 each per standard 53' trailer
SS-793 Gallons	11 each per standard 53' trailer

## SPECIFIC GRAVITY / WEIGHT PER GALLON

Precision IBC Stainless Steel Tank	1.9 specific gravity / 15.85lbs. per gallon
------------------------------------	---

## CONVERSION TABLE

1 Gallon	3.785 liters	Example: 350 gallons x 3.785 liters = 1,324.75 liters
1 liter	0.264 gallon	Example: 1,000 liters x 0.264 gallon = 264 gallons
1 pound	0.4535 kg	Example: 100 lbs x 0.4535kg = 45.35 lbs
1 kg	2.2 lbs	Example: 100 kg x 2.2 lbs = 220 kg







# BELIEVE IN BETTER SERVICE



## PRECISION IBC LOCATIONS

### **FAIRHOPE, ALABAMA**

8054 McGowin Drive  
Fairhope, AL 36532  
800.544.7069 | Ph: 251.990.6789  
Fax: 251.990.6787

### **BROUSSARD, LOUISIANA**

100 Precision Drive  
Broussard, LA 70518  
888.805.1247 | Ph: 337.839.1666  
Fax: 337.839.2666

### **CHICAGO, ILLINOIS**

Ph: 708.396.0750  
Fax: 708.396.0752